

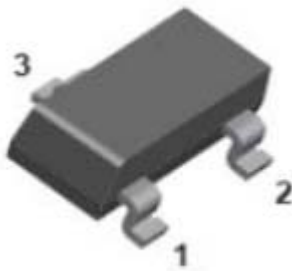

Schottky Barrier Diode

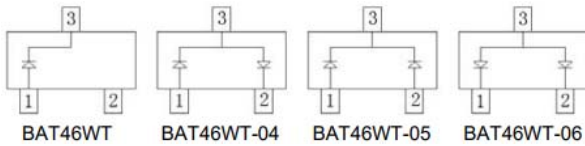

Features

- Moisture sensitivity level 1
- Reverse voltage: 100V
- Average forward current : 150mA

Application

- High frequency and low voltage rectifier

Mechanical data

- **Package:** SOT-323
- **Terminals:** Tin plated leads, solderable per J-STD-002 and JESD22-B102

■ Maximum Ratings (T_a=25°C Unless otherwise specified)

Parameter	Symbol	Unit	Value	
Device marking code			BAT46WT	S91
			BAT46WT-04	S92
			BAT46WT-05	S93
			BAT46WT-06	S94
Repetitive peak reverse voltage	V _{RRM}	V	100	
Forward current, per leg	I _F	mA	150	
Non-repetitive surge peak forward current @ t=8.3ms half-sine wave	I _{FSM}	A	0.75	
Non-repetitive surge peak forward current @ t=1ms square wave			8	
Power dissipation	P _D	mW	200	



BAT46WT/BAT46WT-04/BAT46WT-05/BAT46WT-06

RoHS

COMPLIANT

Parameter	Symbol	Unit	Value
Junction temperature	T_J	°C	-55 to +125
Storage temperature	T_{STG}	°C	-55 to +125

■ **Electrical Characteristics** ($T_a=25^{\circ}\text{C}$ Unless otherwise specified)

Parameter	Symbol	UNIT	Conditions	Min	Typ	Max
Reverse voltage	V_R	V	$I_R=0.1\text{mA}$	100		
Forward voltage	V_{F1}	V	$I_{FM}=0.1\text{mA}$			0.25
	V_{F2}	V	$I_{FM}=10\text{mA}$			0.45
	V_{F3}	V	$I_{FM}=250\text{mA}$			1
Reverse leakage current	I_{R1}	μA	$V_R=1.5\text{V}$			0.3
	I_{R2}	μA	$V_R=10\text{V}$			0.5
	I_{R3}	μA	$V_R=50\text{V}$			1
	I_{R4}	μA	$V_R=75\text{V}$			2
Junction capacitance	C_{j1}	pF	$V_R=1.0\text{V}, f=1\text{MHz}$			12
	C_{j2}	pF	$V_R=0\text{V}, f=1\text{MHz}$			20

■ **Thermal Characteristics**

Parameter	Symbol	Unit	Value
Thermal resistance, junction-to-ambient	$R_{\theta J-A}^{(1)}$	$^{\circ}\text{C/W}$	500
Thermal resistance, junction-to-case	$R_{\theta J-C}^{(1)}$	$^{\circ}\text{C/W}$	400

Note:

(1) Device mounted on PCB, single-sided copper, with standard footprint



■ Characteristics

Fig 1: P_D - T_a Curve

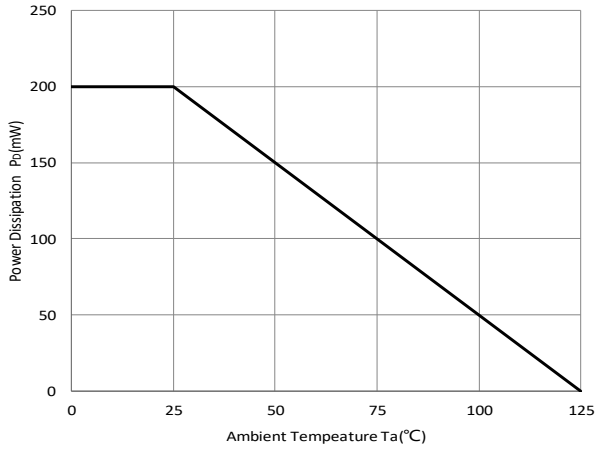

Fig 2: Capacitance Capability

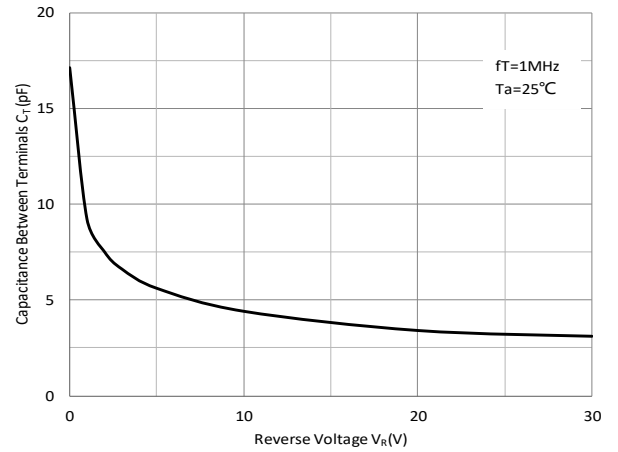

Fig 3: Typical Forward Characteristics

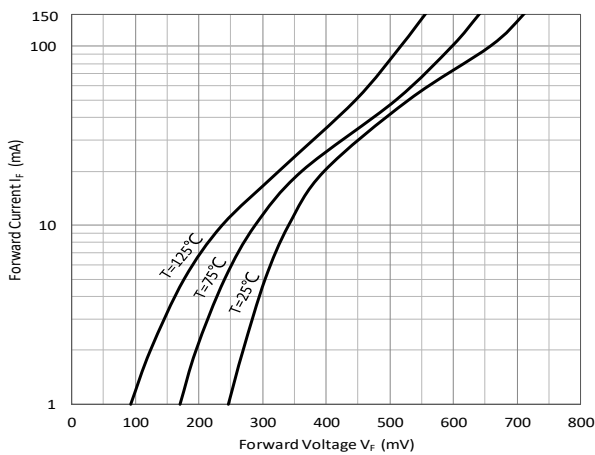
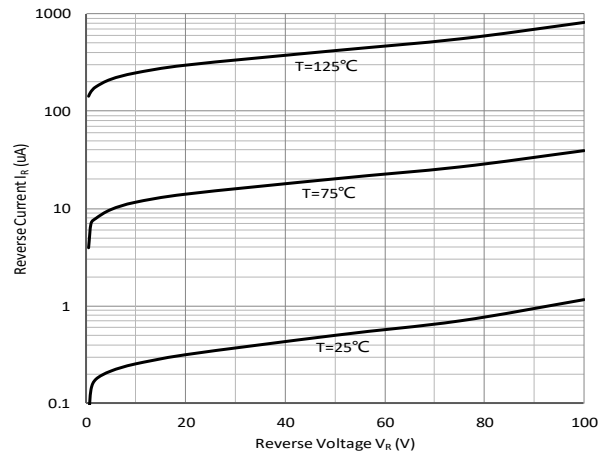

Fig 4: Typical Reverse Characteristics





■ Ordering Information

Preferred P/N	Packing code	Unit weight(g)	Minimum package(pcs)	Inner box quantity(pcs)	Outer carton quantity (pcs)	Delivery mode
BAT46WT THRU BAT46WT-06	F2	Approximate 0.005	3000	30000	120000	7" reel

■ Outline Dimensions

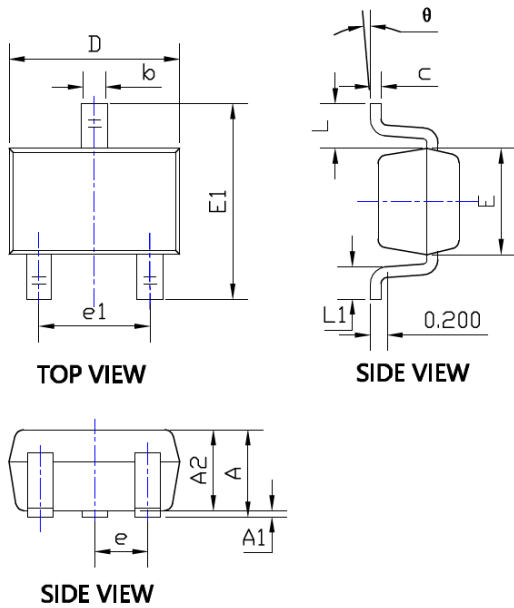

SYMBOL	DIMENSIONS			
	INCHES		Millimeter	
	MIN.	MAX.	MIN.	MAX.
A	0.035	0.043	0.900	1.100
A1	0.000	0.004	0.000	0.100
A2	0.035	0.039	0.900	1.000
b	0.006	0.016	0.150	0.400
c	0.004	0.010	0.100	0.250
D	0.071	0.087	1.800	2.200
E	0.045	0.053	1.150	1.350
E1	0.085	0.096	2.150	2.450
e	0.026 TYP		0.650 TYP	
e1	0.047	0.055	1.200	1.400
L	0.021 REF		0.525 REF	
L1	0.010	0.018	0.260	0.460
θ	0°	8°	0°	8°

■ Suggested Pad Layout

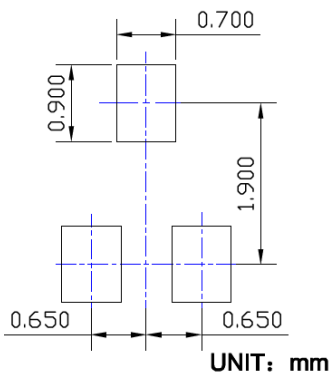



Disclaimer

The information presented in this document is for reference only. Yangzhou Yangjie Electronic Technology Co., Ltd. reserves the right to make changes without notice for the specification of the products displayed herein to improve reliability, function, or design or otherwise.

The product listed herein is designed to be used with ordinary electronic equipment or devices, and not designed to be used with equipment or devices which require high level of reliability and the malfunction of which would directly endanger human life (such as medical instruments, transportation equipment, aerospace machinery, nuclear-reactor controllers, fuel controllers and other safety devices), Yangjie or anyone on its behalf, assumes no responsibility or liability for any damages resulting from such improper use of sale.

This publication supersedes & replaces all information previously supplied. For additional information, please visit our website [http:// www.21yangjie.com](http://www.21yangjie.com) , or consult your nearest Yangjie's sales office for further assistance.